



Shelving systems

Stable construction, simple assembly

Shelving systems in classical unit widths of 1000 or 1300 mm are suitable for every application, for every inventory type and for every kind of storage organisation. The system meets every requirement – from a "simple" unit with shelves up to a completely equipped storage facility with supplements. Thanks to its shelving system with plug-together assembly, Lista has the perfect solution to challenging space issues.



Double-stacking option

The non-screwed, plug-together assembly of all the basic components allows simple and fast installation, even for a double-stack set-up. This gives you double the space utilisation of a comparable single-stack layout.

i Benefits

- For storage of small and medium-sized parts
- Access protection thanks to side and rear panels
- Rear, side and intermediate gratings ensure optimum ventilation
- Can be locked by hinged and sliding doors
- Load capacity of 100-400 kg per shelf and up to 2800 kg per shelving unit
- High flexibility thanks to a wide range of fitting options and partition material
- Multi-stack systems possible
- Simple retrofitting and fast assembly
- Can be extended later

10
Years
Guarantee

The shelving systems can be extended almost endlessly. Whether in a single- or double-stack layout, shelving systems are a stable and space-saving storage option.



Shelving systems



Colours

Units available in 12 standard colours. Multi-colour painting also possible. When ordering, please use the desired three-digit colour code (instead of XXX). Customised colours on request.

➤➤ For colour information see bookmark or fold-out



Shelving systems

Stability and flexibility

Sophisticated design



Shelf supports

The basis of the shelving system is a pair of shelf supports with a maximum load capacity of 2800 kg. High stability is ensured by six edge turns.



Horizontal braces

In conjunction with the shelf supports, the horizontal braces form the side frame. To increase load capacity, additional horizontal braces can be employed in each shelving unit.



Side panel covers

The side panel cover is used as a plain filler panel to cover the open side frame and can be attached without any screws.



Rear gratings

The grating is the optimum solution for preventing access and ensuring transparency at the same time.



Rear panel, perforated

Provides high stability and enables storage of tools on the back of the unit.



Organising rail

The crossbars enable vertical storage of materials.



Equipped to meet your needs

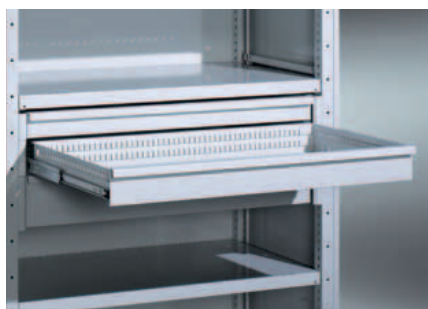

Drawers

The smooth-running drawers with full extension are the optimum storage area for small parts. Available only for units with the dimensions 1000 x 500 mm (W x D).



Shelves and dividers

The shelves feature load capacities ranging from 100 to 400 kg. The shelves are available with rows of slots for subdivision with dividers.



Shelf front cover strips and drip trays

Shelf front cover strips or drip trays can be installed to enable you to store and arrange loose material and liquids tidily and neatly.



Hinged doors

Hinged or sliding doors can be installed on the front to provide reliable access and dust protection. Hinged doors are equipped with a clasp lock and safety cylinder or Code Lock.



Sliding doors

The sliding doors are the optimum solution for tight spaces and come with a lock-down cylinder lock as standard.

Two stacks, double storage area

Full utilisation of the height of the room is also possible with double-stack shelving systems in 1000 and 1300 unit widths. This gives you double the space utilisation of a comparable single-stack layout. The non-screwed, plug-together assembly of all the basic components

allows simple and fast installation, even for a double-stack set-up. An extension unit is fitted to the bottom shelf supports, extending them upwards. The specified dimensions of the shelving systems – unit widths, shelving depths, support heights and the regulation

dimensions for main and secondary alleys – provide the dimensions of your shelving system. In addition Lista offers a complete planning and installation service on request.

Shelving systems

Planning information Shelving dimensions

10
Years
Guarantee

50
kg

**100 to
400**

**to
2800**



**1 2
3 4**

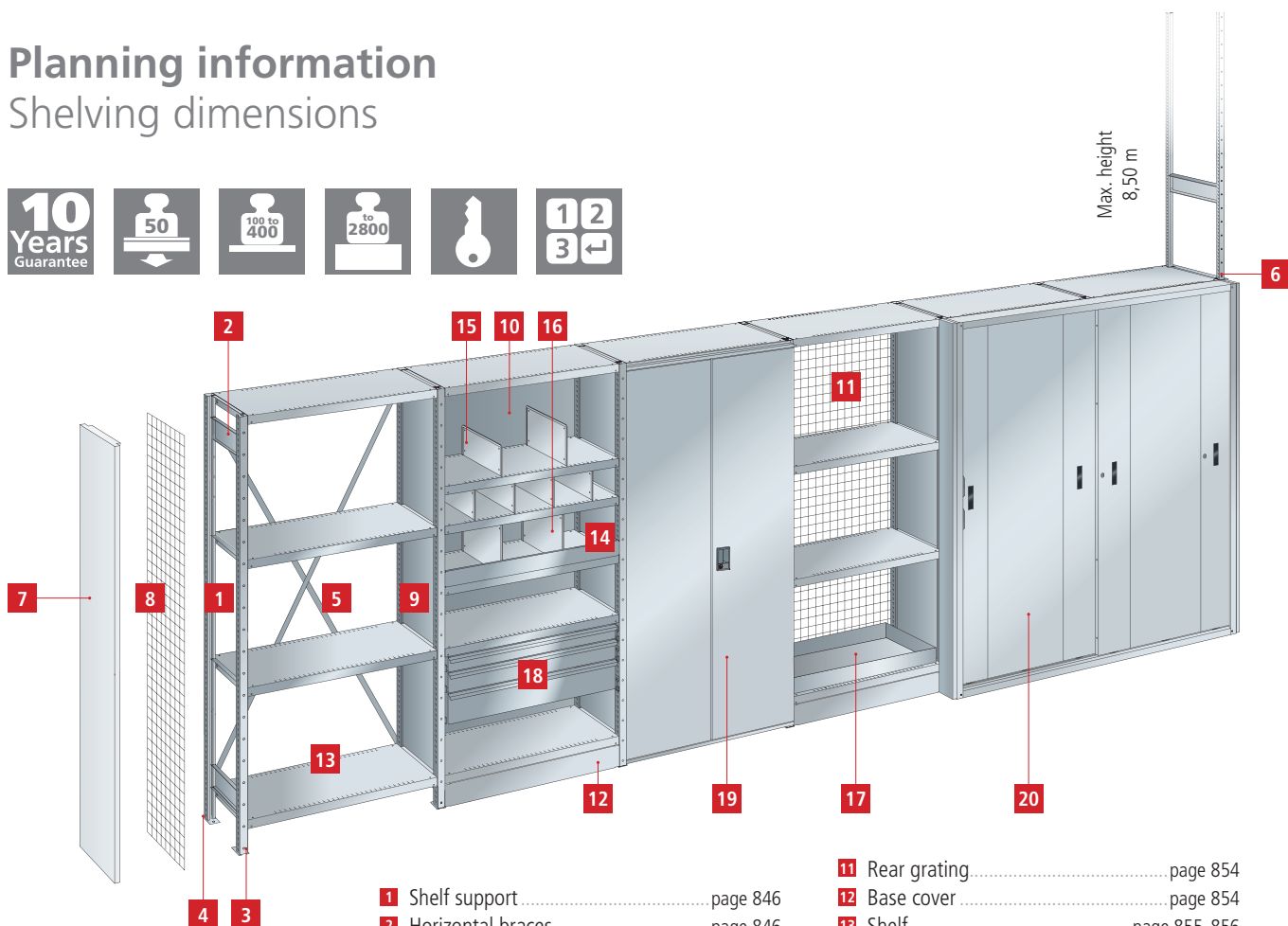

- | | | | |
|----------------------------------|----------|---|--------------|
| 1 Shelf support | page 846 | 11 Rear grating | page 854 |
| 2 Horizontal braces | page 846 | 12 Base cover | page 854 |
| 3 Levelling plates | page 847 | 13 Shelf | page 855-856 |
| 4 Anchoring set | page 847 | 14 Shelf front cover strip | page 858 |
| 5 Diagonal brace | page 847 | 15 Divider | page 858 |
| 6 Extension unit | page 847 | 16 Shelf divider | page 858 |
| 7 Side panel cover | page 848 | 17 Drip tray | page 859 |
| 8 Grating cover | page 849 | 18 Drawer | page 861 |
| 9 Partition | page 850 | 19 Hinged door | page 862 |
| 10 Rear panel | page 852 | 20 Sliding door | page 863 |
| | | ■ Brackets/crossbars | page 859 |

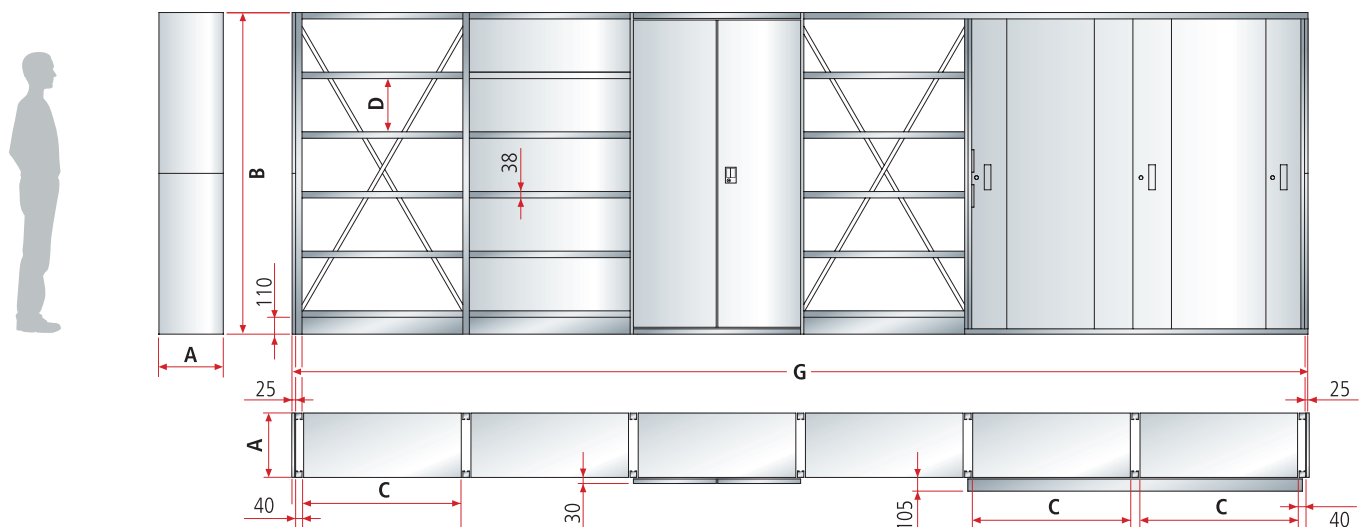

A = Shelving depth
B = Shelving height

C = Shelving width
D = Clear height

G = Number of shelf installation widths + number of shelf support widths 40 mm (+ side panel covers 25 mm)
Example: 6 x 1000 mm + 7 x 40 mm + 2 x 25 mm = 6,330 mm

Shelving depths (A)

D  Nominal dimensions mm	300	400	500	600	800
With hinged doors	331	431	537	637	837
With sliding doors	406	506	612	712	912
With side panel cover	301	401	507	607	807

Usable depths mm

Shelves	294	304	500	600	800
Drawer ¹	-	-	459	-	-

¹ Drawers can be fitted only in the units with the dimensions 1000 x 507 mm (W x D).

Shelf heights (B)

H  Nominal dimensions mm	2000	2200	2500	3000
With hinged doors	2000	2200	2500	-
With sliding doors	2000	2200	2500	-

Slots, vertical

Slots in the side frame	every 25 mm, for attaching shelf holders
Clear height (D) between the shelves	= Number of visible slots x 25 mm

Shelf widths (C)

W  Axial dimensions mm	1040	1340
Shelf support width	40	40
Shelf installation width	1000	1300

Slots, horizontal

Slots in the shelves	every 25 mm, for subdivision using dividers and shelf dividers
----------------------	--

Front-mounting variants

Immediately adjacent front-mounting variants

Basic unit left	Add-on side right	
	Hinged door	Sliding door
Hinged door	●	-
Sliding door	-	●
Drawers ³	●	●

● possible - not possible

² for fitting behind front assembly



Shelving systems

Basic and add-on units

Each basic unit consists of:

- a) 2 pairs of shelf supports
- b) 4 horizontal braces
- c) 1 diagonal brace

Each add-on unit consists of:

- a) 1 pair of shelf supports
- b) 2 horizontal braces

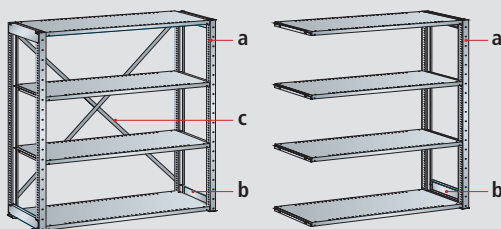

Important:

- For shelves, see separate components.
- Both the maximum load capacity of the shelves and the maximum unit loads must be observed.
- For each pair of shelf supports, a minimum of 2 horizontal braces must be provided. However, these do not influence the load capacity, but only serve to stabilise the shelving unit.



Diagonal brace arrangement

The load capacities are only valid if, from 6 shelving sections upwards, 2 shelving sections or at least every 5th is equipped with rear panels or 1 diagonal brace is fitted for every 3 shelving sections. In double-stack systems, diagonal braces or panels must be fitted in the lower stack in every 3rd shelving unit.

Anchoring rule

Units with a depth to height ratio greater than 1:5 (1:4 for units with hinged doors and for single units with drawers) must be anchored.

Planning information

Load capacities

Load capacities of shelf heights 2000 mm, 2200 mm and 2500 mm

The permitted unit load of the shelving systems with a height of 2000, 2200 and 2500 mm is 2800 kg, regardless of the shelf spacing.

H ↑ 2000 / 2200 / 2500 mm	Permitted shelving unit load	
	kg	
	Shelf spacing mm	All shelves
	Not relevant	2800 kg

Load capacities of shelving height 3000 mm

With a shelving system height of 3000 mm, the permitted unit load is reduced if the shelf spacing less than 500 mm. This only applies if the shelves are carrying their full load weight and the unit is filled from the top down. If the shelves are filled bottom up or loaded evenly, the permitted unit load remains 2800 kg.

Example: in the case of a shelving height of 3000 mm, with shelf spacing of 325 mm, the permitted unit load remains 2800 kg if the shelves have a load capacity of 110 kg. If the shelves have a load capacity of 300 kg, the permitted unit load is reduced to 2450 kg, and if the shelves have a load capacity of 400 kg, it is reduced to 2200 kg.

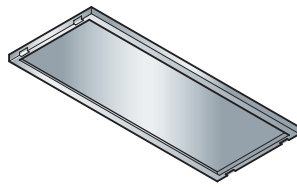
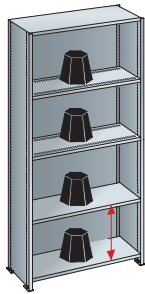

Shelf without strengthener

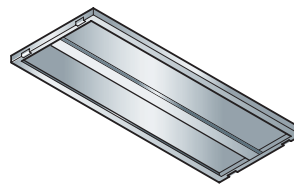

Shelf with 1 strengthener

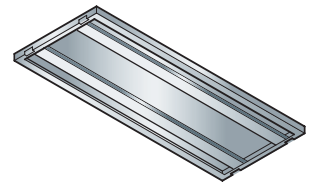

Shelf with 2 strengtheners

H ↑ 3000 mm	Permitted shelving unit load of shelf with load capacity		
	kg		
Shelf spacing mm	110 kg ¹ / 100 kg ²	300 kg ¹ / 250 kg ²	400 kg ¹ / 300 kg ²
850	2800 kg	2800 kg	2800 kg
825	2800 kg	2800 kg	2800 kg
800	2800 kg	2800 kg	2800 kg
775	2800 kg	2800 kg	2800 kg
750	2800 kg	2800 kg	2800 kg
725	2800 kg	2800 kg	2800 kg
700	2800 kg	2800 kg	2800 kg
675	2800 kg	2800 kg	2800 kg
650	2800 kg	2800 kg	2800 kg
625	2800 kg	2800 kg	2800 kg
600	2800 kg	2800 kg	2800 kg
575	2800 kg	2800 kg	2800 kg
550	2800 kg	2800 kg	2800 kg
525	2800 kg	2800 kg	2800 kg
500	2800 kg	2800 kg	2800 kg
475	2800 kg	2800 kg	2740 kg
450	2800 kg	2800 kg	2670 kg
425	2800 kg	2800 kg	2600 kg
400	2800 kg	2800 kg	2520 kg
375	2800 kg	2800 kg	2450 kg
350	2800 kg	2600 kg	2370 kg
325	2800 kg	2450 kg	2200 kg
300	2800 kg	2300 kg	2000 kg
275	2800 kg	2200 kg	1950 kg
250	2800 kg	2100 kg	1900 kg

¹ Load capacity with shelf width 1000 mm / ² Load capacity with shelf width 1300 mm



Shelving accessories

Shelf supports, horizontal braces



Pair of shelf supports

The pair of shelf supports consists of 2 shelf supports and 2 base plates (without horizontal braces). Slots are 25 mm apart for attaching the shelf supports at any height. The parts (supports, base plates) are supplied unmounted. Screw connections included. Specification: shelf supports 40 x 40 mm made of C profile, cold-rolled, 6 edge turns for high stability. Colour: shelf support galvanised or according to colour chart. Base plate galvanised. Max. load capacity 2800 kg.

H ↑ 2000 mm

Specification	Art. no.	
Galvanised	55.282.000	
Painted	55.283.XXX	

H ↑ 2200 mm

Specification	Art. no.	
Galvanised	55.284.000	
Painted	55.285.XXX	

H ↑ 2500 mm

Specification	Art. no.	
Galvanised	55.286.000	
Painted	55.287.XXX	

H ↑ 3000 mm

Specification	Art. no.	
Galvanised	55.288.000	
Painted	55.289.XXX	

Horizontal braces

In conjunction with 2 shelf supports respectively, the horizontal braces form the side frame. To increase load capacity, additional horizontal braces are employed in each shelving unit. See load capacities. Specification: galvanised sheet steel.



For shelving depth mm	Art. no.	
300	55.276.000	
400	55.277.000	
500	55.278.000	
600	55.279.000	
800	55.280.000	



Stabilising elements

Diagonal braces

Used to stabilise shelving systems, instead of rear panels. Fitting material included.

Specification: steel, galvanised. For the number of diagonal braces see planning information on page 843.

For shelf width mm	Shelving height mm	Art. no.	
1000	2000, 2200, 2500, 3000	55.328.000	
1300	2000, 2200, 2500, 3000	55.330.000	



Extension device

To heighten the shelving, extension units are fitted into the existing shelf supports and are each secured with 4 through bolts. The extension units must be inserted at least 50 mm into the existing shelf supports. The top shelf must be removed first. Specification: made of galvanised sheet steel. Including fitting material for one pair of shelf supports. The static calculations for the extensions are performed by the Lista specialists. Transfer stations and steps for pallets as well as intermediate shelves are available on requests.

Designation	Specification	Art. no.	
Extension device	Per pair	55.383.000	

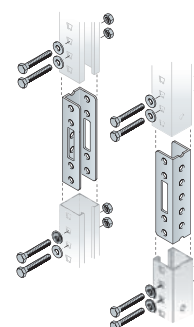

Levelling plates

To adjust the height. Also enable it to be aligned with precision on uneven floors.

Specification: PVC. Colour: grey

Depth mm	Width mm	Thickness mm	Art. no.	
80	50	1	55.175.000	
80	50	2	55.176.000	
80	50	4	55.177.000	

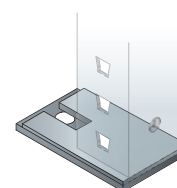

Floor anchoring

Units with a depth to height ratio greater than 1:5, (1:4 for units with hinged doors), and single units with drawers must be anchored.

Number of anchors:

For single units: 2 per pair of shelf supports

For double units: 2 per pair of double shelf supports (only the outer shelf supports)

Designation	Specification	Art. no.	
Floor anchor M10 x 90	per piece	55.226.000	

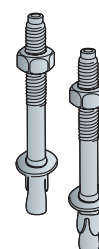

Shelving accessories

Side panels, gratings



Side panel covers

Plain panel cover to cover the lateral rows of slots in the side frame. The panel covers are 1-piece up to a height of 2200 mm, 2-piece above that. They are attached and secured above the horizontal braces. The horizontal braces must be inserted at a height of 125 mm at the bottom and flush at the top. Including 2 horizontal braces. Specification: sheet steel. Colour: according to colour chart.

H ↑ 2000 mm

Nominal depth mm	Width mm	Number of parts	Art. no. 	
300	25	1	55.300.XXX	
400	25	1	55.306.XXX	
500	25	1	55.128.XXX	
600	25	1	55.131.XXX	
800	25	1	55.318.XXX	

H ↑ 2200 mm

Nominal depth mm	Width mm	Number of parts	Art. no. 	
300	25	1	55.301.XXX	
400	25	1	55.307.XXX	
500	25	1	55.129.XXX	
600	25	1	55.132.XXX	
800	25	1	55.319.XXX	



H ↑ 2500 mm

Nominal depth mm	Width mm	Number of parts/part dimensions	Art. no. 	
300	25	2 x 1000/1500 mm	55.302.XXX	
400	25	2 x 1000/1500 mm	55.308.XXX	
500	25	2 x 1000/1500 mm	55.130.XXX	
600	25	2 x 1000/1500 mm	55.133.XXX	
800	25	2 x 1000/1500 mm	55.320.XXX	

H ↑ 3000 mm

Nominal depth mm	Width mm	Number of parts/part dimensions	Art. no. 	
300	25	2 x 1500 mm	55.303.XXX	
400	25	2 x 1500 mm	55.309.XXX	
500	25	2 x 1500 mm	55.312.XXX	
600	25	2 x 1500 mm	55.315.XXX	
800	25	2 x 1500 mm	55.321.XXX	



Grating covers

Side grating cover. The gratings are fastened to the outer side frame.

The grating covers are 1-piece up to a height of 2200 mm, 2-piece above that.

Specification: 3.0 mm steel wire, mesh size 50 x 50 mm, electrolytically galvanised.

H ↑ 2000 mm

Nominal depth mm	Number of parts	Art. no.	
300	1	55.392.000	
400	1	55.396.000	
500	1	55.400.000	
600	1	55.404.000	
800	1	55.408.000	

H ↑ 2200 mm

Nominal depth mm	Number of parts	Art. no.	
300	1	55.393.000	
400	1	55.397.000	
500	1	55.401.000	
600	1	55.405.000	
800	1	55.409.000	

H ↑ 2500 mm

Nominal depth mm	Number of parts/part dimensions mm	Art. no.	
300	2 x 1250	55.394.000	
400	2 x 1250	55.398.000	
500	2 x 1250	55.402.000	
600	2 x 1250	55.406.000	
800	2 x 1250	55.410.000	

H ↑ 3000 mm

Nominal depth mm	Number of parts/part dimensions	Art. no.	
300	2 x 1500 mm	55.395.000	
400	2 x 1500 mm	55.399.000	
500	2 x 1500 mm	55.403.000	
600	2 x 1500 mm	55.407.000	
800	2 x 1500 mm	55.411.000	

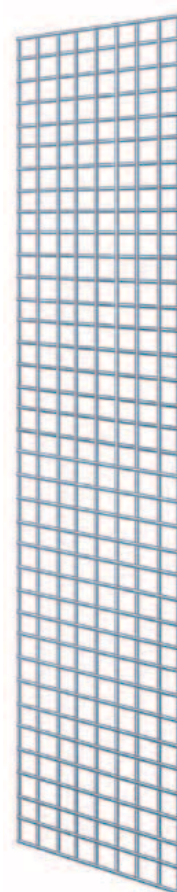

Shelving accessories

Partitions



Partitions

Plain 2-piece sheet steel partition. It is placed between the shelf supports and clamped by the shelf supports on the right and left.
Specification: 5 mm sheet steel. Colour: galvanised or according to colour chart.

H ↑ 2000 mm

Depth mm	Specification	Number of parts/ part dimensions mm	Art. no. 	
300	Galvanised	2 x 1000	55.232.000	
400	Galvanised	2 x 1000	55.244.000	
500	Galvanised	2 x 1000	55.150.000	
600	Galvanised	2 x 1000	55.156.000	
800	Galvanised	2 x 1000	55.268.000	
300	Painted	2 x 1000	55.233.XXX	
400	Painted	2 x 1000	55.245.XXX	
500	Painted	2 x 1000	55.151.XXX	
600	Painted	2 x 1000	55.157.XXX	
800	Painted	2 x 1000	55.269.XXX	

H ↑ 2200 mm

Depth mm	Specification	Number of parts/ part dimensions mm	Art. no. 	
300	Galvanised	2 x 1000/1200	55.234.000	
400	Galvanised	2 x 1000/1200	55.246.000	
500	Galvanised	2 x 1000/1200	55.152.000	
600	Galvanised	2 x 1000/1200	55.158.000	
800	Galvanised	2 x 1000/1200	55.270.000	
300	Painted	2 x 1000/1200	55.235.XXX	
400	Painted	2 x 1000/1200	55.247.XXX	
500	Painted	2 x 1000/1200	55.153.XXX	
600	Painted	2 x 1000/1200	55.159.XXX	
800	Painted	2 x 1000/1200	55.271.XXX	

H ↑ 2500 mm

Depth mm	Specification	Number of parts/ part dimensions mm	Art. no. 	
300	Galvanised	2 x 1000/1500	55.236.000	
400	Galvanised	2 x 1000/1500	55.248.000	
500	Galvanised	2 x 1000/1500	55.154.000	
600	Galvanised	2 x 1000/1500	55.160.000	
800	Galvanised	2 x 1000/1500	55.272.000	
300	Painted	2 x 1000/1500	55.237.XXX	
400	Painted	2 x 1000/1500	55.249.XXX	
500	Painted	2 x 1000/1500	55.155.XXX	
600	Painted	2 x 1000/1500	55.161.XXX	
800	Painted	2 x 1000/1500	55.273.XXX	

H ↑ 3000 mm

Depth mm	Specification	Number of parts/ part dimensions mm	Art. no. 	
300	Galvanised	2 x 1500	55.238.000	
400	Galvanised	2 x 1500	55.250.000	
500	Galvanised	2 x 1500	55.256.000	
600	Galvanised	2 x 1500	55.262.000	
800	Galvanised	2 x 1500	55.274.000	
300	Painted	2 x 1500	55.239.XXX	
400	Painted	2 x 1500	55.251.XXX	
500	Painted	2 x 1500	55.257.XXX	
600	Painted	2 x 1500	55.263.XXX	
800	Painted	2 x 1500	55.275.XXX	

Partition gratings

The gratings are placed into the side frame. They are stabilised by the shelf supports of the shelving system.

The partition gratings are one-piece up to a height of 2200 mm, 2-piece above that.

Specification: 3.0 mm steel wire, mesh size 50 x 50 mm, electrolytically galvanised.

H 2000 mm

Depth mm	Number of parts	Art. no.	
300	1	55.412.000	
400	1	55.416.000	
500	1	55.420.000	
600	1	55.424.000	
800	1	55.428.000	

H 2200 mm

Depth mm	Number of parts	Art. no.	
300	1	55.413.000	
400	1	55.417.000	
500	1	55.421.000	
600	1	55.425.000	
800	1	55.429.000	

H 2500 mm

Depth mm	Number of parts/part dimensions mm	Art. no.	
300	2 x 1250	55.414.000	
400	2 x 1250	55.418.000	
500	2 x 1250	55.422.000	
600	2 x 1250	55.426.000	
800	2 x 1250	55.430.000	

H 3000 mm

Depth mm	Number of parts/part dimensions mm	Art. no.	
300	2 x 1500	55.415.000	
400	2 x 1500	55.419.000	
500	2 x 1500	55.423.000	
600	2 x 1500	55.427.000	
800	2 x 1500	55.431.000	

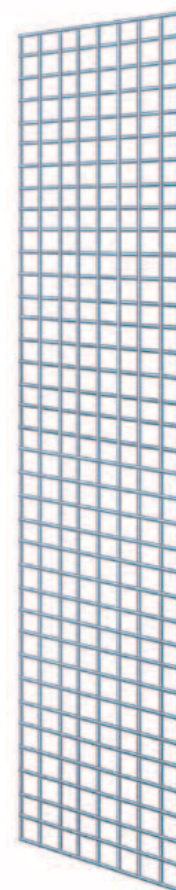

i Tip

Partitions

When the shelving unit is equipped with hinged doors or sliding doors, the partitions prevent uncontrolled access.



Shelving accessories

Rear panels



Rear panels

The rear panel cover for shelving sections also stabilises the shelving unit longitudinally. The 2-piece rear panels and the side frame are screwed together. Including fastening material and plastic joint profile. Specification: sheet steel. Colour: galvanised or according to colour chart, joint profile black.

H ↑ 2000 mm

For shelf width mm	Specification	Number of parts/ part dimensions mm	Art. no. 	
1000	Galvanised	2 x 1000	55.134.000	
1300	Galvanised	2 x 1000	55.140.000	
1000	Painted	2 x 1000	55.135.XXX	
1300	Painted	2 x 1000	55.141.XXX	

H ↑ 2200 mm

For shelf width mm	Specification	Number of parts/ part dimensions mm	Art. no. 	
1000	Galvanised	2 x 1000/1200	55.136.000	
1300	Galvanised	2 x 1000/1200	55.142.000	
1000	Painted	2 x 1000/1200	55.137.XXX	
1300	Painted	2 x 1000/1200	55.143.XXX	

H ↑ 2500 mm

For shelf width mm	Specification	Number of parts/ part dimensions mm	Art. no. 	
1000	Galvanised	2 x 1000/1200	55.138.000	
1300	Galvanised	2 x 1000/1200	55.144.000	
1000	Painted	2 x 1000/1200	55.139.XXX	
1300	Painted	2 x 1000/1200	55.145.XXX	

H ↑ 3000 mm

For shelf width mm	Specification	Number of parts/ part dimensions mm	Art. no. 	
1000	Galvanised	2 x 1200	55.224.000	
1300	Galvanised	2 x 1200	55.326.000	
1000	Painted	2 x 1200	55.225.XXX	
1300	Painted	2 x 1200	55.327.XXX	



Perforated rear panels

The rear panel cover for shelving sections also stabilises the shelving unit longitudinally. The 2-piece rear panels and the side frame are screwed together. Including fastening material and plastic joint profile. Specification: sheet steel with round holes, Ø 3.6 mm and 19 mm apart as well as square holes, 10 x 10 mm and 38 mm apart. To hold keyhole hooks (see page 630 ff). Colour: galvanised or according to colour chart, joint profile black.

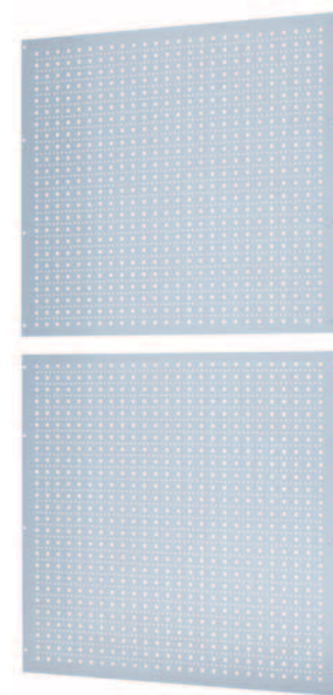

H ↑ 2000 mm

For shelf width mm	Specification	Number of parts/ part dimensions mm	Art. no. 	
1000	Galvanised	2 x 1000	53.800.000	
1300	Galvanised	2 x 1000	53.804.000	
1000	Painted	2 x 1000	53.808.XXX	
1300	Painted	2 x 1000	53.812.XXX	

H ↑ 2200 mm

For shelf width mm	Specification	Number of parts/ part dimensions mm	Art. no. 	
1000	Galvanised	2 x 1000/1200	53.801.000	
1300	Galvanised	2 x 1000/1200	53.805.000	
1000	Painted	2 x 1000/1200	53.809.XXX	
1300	Painted	2 x 1000/1200	53.813.XXX	

H ↑ 2500 mm

For shelf width mm	Specification	Number of parts/ part dimensions mm	Art. no. 	
1000	Galvanised	2 x 1000/1200	53.802.000	
1300	Galvanised	2 x 1000/1200	53.806.000	
1000	Painted	2 x 1000/1200	53.810.XXX	
1300	Painted	2 x 1000/1200	53.814.XXX	

H ↑ 3000 mm

For shelf width mm	Specification	Number of parts/ part dimensions mm	Art. no. 	
1000	Galvanised	2 x 1200	53.803.000	
1300	Galvanised	2 x 1200	53.807.000	
1000	Painted	2 x 1200	53.811.XXX	
1300	Painted	2 x 1200	53.815.XXX	

Shelving accessories

Rear panels

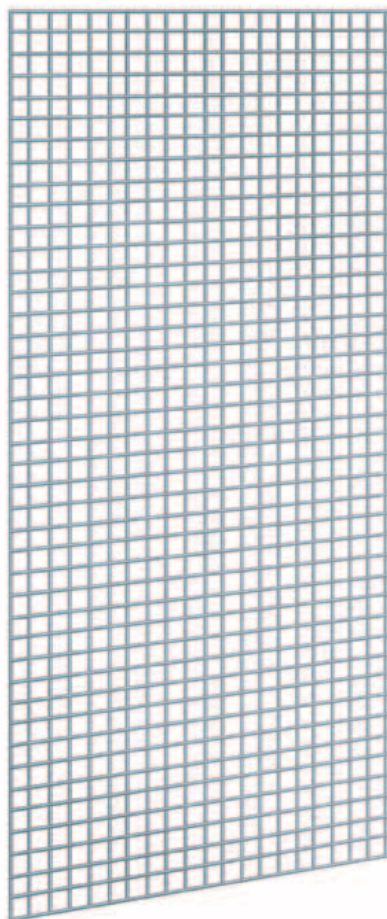

Rear gratings

Rear grating for shelving sections. The rear gratings and the side frame are screwed together.

The rear gratings are 1-piece up to a height of 2200 mm, 2-piece above that. Fastening material included.

Specification: 3.0 mm steel wire, mesh size 50 x 50 mm, electrolytically galvanised.

H ↑ 2000 mm

For shelf width mm	Number of parts	Art. no.	
1000	1	55.384.000	
1300	1	55.388.000	

H ↑ 2200 mm

For shelf width mm	Number of parts	Art. no.	
1000	1	55.385.000	
1300	1	55.389.000	

H ↑ 2500 mm

For shelf width mm	Number of parts/part dimensions mm	Art. no.	
1000	2 x 1250	55.386.000	
1300	2 x 1250	55.390.000	

H ↑ 3000 mm

For shelf width mm	Number of parts/part dimensions mm	Art. no.	
1000	2 x 1500	55.387.000	
1300	2 x 1500	55.391.000	

i Tip

Stabilisation

To stabilise the shelving systems longitudinally, diagonal braces must be used in addition to the rear grating.



Shelves, base covers

Slotted shelves

Shelves for the shelving system. With front and rear row of slots, slots 25 mm apart. The shelves are folded on the long side by 4 x 90°, on the narrow side by 2 x 90°: for stabilisation and as protection from injury. Shelf height 38 mm. Including 2 shelf supports per shelf. Specification: sheet steel. Colour: galvanised.

W → 1000 mm

Fachböden geschlitzt, verzinkt

Depth mm	kg	Number of strengtheners	Art. no.	
300	110	0	55.180.000	
400	110	0	55.182.000	
400	300	1	55.184.000	
500	100	0	55.120.000	
500	300	1	55.186.000	
500	400	2	55.188.000	
600	100	0	55.122.000	
600	300	1	55.190.000	
600	400	2	55.192.000	
800	100	0	55.194.000	
800	250	1	55.196.000	
800	400	2	55.198.000	

Slotted shelves, painted

Shelf support galvanised.

Depth mm	kg	Number of strengtheners	Art. no.	
300	110	0	55.181.XXX	
400	110	0	55.183.XXX	
400	300	1	55.185.XXX	
500	100	0	55.121.XXX	
500	300	1	55.187.XXX	
500	400	2	55.189.XXX	
600	100	0	55.123.XXX	
600	300	1	55.191.XXX	
600	400	2	55.193.XXX	
800	100	0	55.195.XXX	
800	250	1	55.197.XXX	
800	400	2	55.199.XXX	

Base covers

Before the lowest shelf is inserted, the base covers are placed to the right and left of the supports and secured by plug-in cover caps. Specification: sheet steel. Colour: galvanised or according to colour chart.

For shelf width mm	Height mm	Specification	Art. no.	
1000	110	Galvanised	55.356.000	
1300	110	Galvanised	55.358.000	
1000	110	Painted	55.357.XXX	
1300	110	Painted	55.359.XXX	



Shelving component parts

Shelves



Slotted shelves

Shelves for the shelving system. With front and rear row of slots, slots 25 mm apart. The shelves are folded on the long side by 4 x 90°, on the narrow side by 2 x 90°: for stabilisation and as protection from injury. Shelf height 38 mm. Including 2 shelf supports per shelf. Specification: sheet steel. Colour: galvanised or according to colour chart.

W → 1300 mm

Slotted shelves, galvanised

Depth mm	kg	Number of strengtheners	Art. no.	
300	100	0	55.200.000	
400	100	0	55.202.000	
400	250	1	55.204.000	
500	100	0	55.124.000	
500	250	1	55.206.000	
500	300	2	55.208.000	
600	100	0	55.126.000	
600	225	1	55.210.000	
600	300	2	55.212.000	
800	100	0	55.214.000	
800	200	1	55.216.000	
800	300	2	55.218.000	

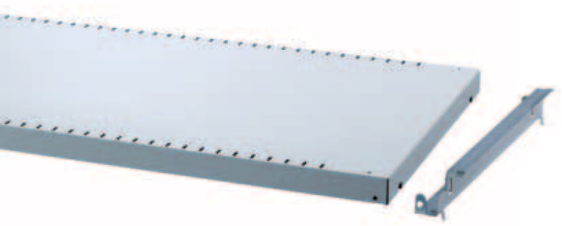

Slotted shelves, painted

Shelf supports galvanised.

Depth mm	kg	Number of strengtheners	Art. no. 	
300	100	0	55.201.XXX	
400	100	0	55.203.XXX	
400	250	1	55.205.XXX	
500	100	0	55.125.XXX	
500	250	1	55.207.XXX	
500	300	2	55.209.XXX	
600	100	0	55.127.XXX	
600	225	1	55.211.XXX	
600	300	2	55.213.XXX	
800	100	0	55.215.XXX	
800	200	1	55.217.XXX	
800	300	2	55.219.XXX	

Shelf accessories

Additional shelf supports

Specification: sheet steel, galvanised. Max. load-bearing capacity per pair 400 kg.

For shelf depth mm	Art. no.	
300	55.375.000	
400	55.376.000	
500	55.377.000	
600	55.378.000	
800	55.379.000	



Additional shelf strengtheners

To increase the shelf load capacity. The strengtheners are snapped into the lateral folds of the shelves. Specification: sheet steel, galvanised.

Strengtheners cannot be used for 300 mm shelf profile.

A maximum of 2 strengtheners can be used for 400 mm shelf depth, 3 strengtheners can be used from 500 mm shelf depth upwards, prices on request.

See shelf table on page 844.

For shelf width mm	Art. no.	
1000	55.380.000	
1300	55.381.000	



i Tip

Strengtheners

The shelves are designed to enable the load capacity to be increased from 100 to 250 kg with a different number of strengtheners.

Shelf, without strengthener
Load capacity up to 100 kg

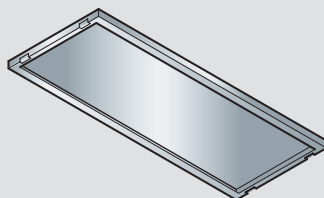

Shelf with 1 strengthener
Load capacity up to 200 kg

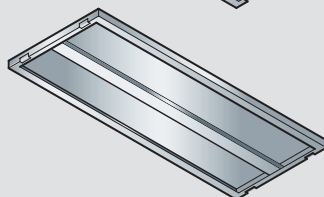

Shelf with 2 strengtheners
Load capacity up to 300 kg

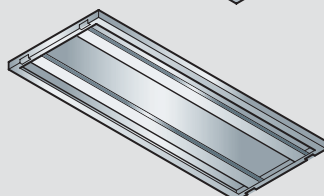

Shelving component parts

Shelf front cover strip, dividers



Shelf front cover strips

The shelf front cover strips are pluggable and are fastened to the shelf supports with cover caps. Specification: sheet steel. Colour: galvanised or according to colour chart.

For shelf width mm	Height mm	Specification	Art. no. 	
1000	75	Galvanised	55.360.000	
1300	75	Galvanised	55.362.000	
1000	75	Painted	55.361.XXX	
1300	75	Painted	55.363.XXX	



Dividers for shelves

For subdividing slotted shelves. Specification: sheet steel, galvanised.

For shelf depth mm	Height mm	Art. no.	
300	150	55.352.000	
400	150	55.353.000	
500	150	55.146.000	
600	150	55.147.000	
800	150	55.354.000	

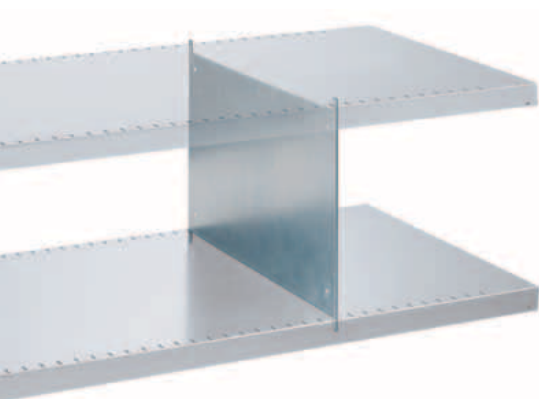

Shelf dividers for shelves

For subdividing slotted shelves. The height of the shelf dividers, inserted at the top and at the bottom, is determined by the shelf spacing. Specification: sheet steel, galvanised.

Shelf top edge to top edge = shelf divider height.

For shelf depth mm	Height top edge to top edge mm	Art. no.	
300	250	55.332.000	
300	300	55.333.000	
300	350	55.334.000	
300	400	55.335.000	
400	250	55.336.000	
400	300	55.337.000	
400	350	55.338.000	
400	400	55.339.000	
500	250	55.340.000	
500	300	55.341.000	
500	350	55.342.000	
500	400	55.343.000	
600	250	55.344.000	
600	300	55.345.000	
600	350	55.346.000	
600	400	55.347.000	
800	250	55.348.000	
800	300	55.349.000	
800	350	55.350.000	
800	400	55.351.000	



Organising rails, drip trays

Organising rails

Organising rail consisting of a crossbar and brackets for vertical storage, compartment division for storage of diverse ring-shaped materials (cables, V-belts, tubes). The crossbar and the rear supports of the side frame are screwed together. The bracket is attached to the crossbar and secured with screws. Crossbar and bracket specification: sheet steel. Colour: according to colour chart.

Crossbars

For shelf width mm	Usable width mm	Art. no. 	
1000	990	53.816.XXX	
1300	1290	53.817.XXX	



brackets

For shelving depth mm	Length mm	Art. no. 	
300	290	53.818.XXX	
400	390	53.819.XXX	
500	490	53.820.XXX	
600	590	53.821.XXX	
800	790	53.822.XXX	



Drip trays

Can be placed on 1000 mm wide shelves loosely. Also removable when hinged doors are used. Specification: sheet steel, galvanised surface. Material thickness: 3 mm. Welded liquid-tight. Designed according to Section 16 WHG (Water Resources Act) / StawaR (German directive on steel trays). The drip tray is leak tested and has a corresponding type plate as well as a test certificate.

Depth mm	Width mm	Height mm	Capacity in litres	Art. no.	
295	940	100	26	53.823.000	
395	940	100	36	53.824.000	
495	940	100	45	53.825.000	
595	940	100	54	53.826.000	
795	940	100	72	53.827.000	

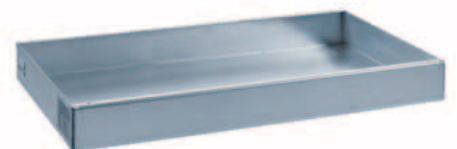

i Tip

Height top edge to top edge

If shelf dividers are to be used, the distance from the shelf top edge to the next shelf top edge must be 250, 300, 350 or 400 mm.



Shelving accessories

Clothes rails and coat hooks



Clothes rails, painted

The clothes rail is fitted separately from the shelves by means of crossbar plates which are attached to the side panel with shelf supports. Shelf supports included. Specification: Rail made of chrome steel, Ø 27 mm, crossbars made of sheet steel. Colour of the crossbars: according to colour chart.

Width mm	Depth mm	Art. no. 	
1000	400	53.830.XXX	
1000	500	53.831.XXX	
1000	600	53.832.XXX	
1000	800	53.839.XXX	
1300	400	53.834.XXX	
1300	500	53.835.XXX	
1300	600	53.836.XXX	
1300	800	53.837.XXX	



Clothes rails, galvanised

The clothes rail is fitted separately from the shelves by means of crossbar plates which are attached to the side panel with shelf supports. Shelf supports included. Specification: rail made of chrome steel, Ø 27 mm, crossbars made of hot galvanised sheet steel.

Width mm	Depth mm	Art. no.	
1000	400	53.838.000	
1000	500	53.833.000	
1000	600	53.840.000	
1000	800	53.841.000	
1300	400	53.842.000	
1300	500	53.843.000	
1300	600	53.844.000	
1300	800	53.845.000	

Coat hook

Coat hook for chrome steel clothes rail, Ø 27 mm, galvanised.

Designation	Specification	Art. no.	
	1 piece	53.916.000	



Drawers



Drawers 54 x 27 E

Drawers for fitting into the units. Installation of drawers is possible at any time. Drawer load capacity with evenly distributed load. Pre-fitted full extensions and fitting material included. Specification: solid-walled steel construction. Drawer colour: similar to light grey, RAL 7035. Drawer front colour: according to colour chart.

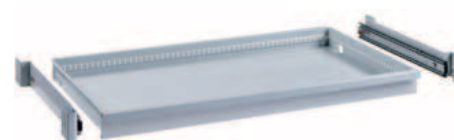
Attention: single units to be fitted with drawers must be anchored according to the assembly instructions.



D  500 mm	for shelving depth	W  1000 mm	Shelving width
--	--------------------	---	----------------

Front height mm	Usable height mm	Usable width mm	Usable depth mm	 kg	Art. no. 	
75	60	918	459	50	55.172.XXX	
100	83	918	459	50	55.173.XXX	
150	133	918	459	50	55.174.XXX	

Drawer safety catch

To be used when the shelving system is used as a sliding shelf unit.

Designation	Art. no.	
Drawer safety catch	13.026.000	



Tip

Matching partition and labelling material

Matching partition and labelling material for the respective drawer (e.g. troughs, plastic boxes, dividers or self-adhesive labels) can be found on page 976.

Please use the corresponding Lista unit **54 x 27 E** as a guide.

18 x 27 E 18 x 36 E 27 x 27 E 27 x 36 E 36 x 27 E 36 x 36 E 45 x 36 E **54 x 27 E**

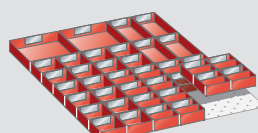
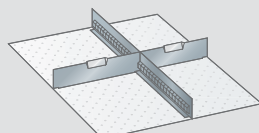

 For partition material 54 x 27 E and labelling system see page 950 ff

Hinged or sliding doors with Key Lock or Code Lock locking systems



Key Lock for hinged doors
Standard closure with clasp lock.



Code Lock for hinged doors
Electronic locking system per number code.

Hinged doors

Hinged with a 2-point bar lock with a recess for a clasp lock (must be ordered separately). The hinged doors can be fitted on all shelf units later.

Specification: sheet steel. Colour: according to colour chart.

Shelving depth with hinged door = Side panel depth + 30 mm

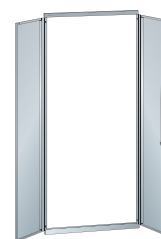
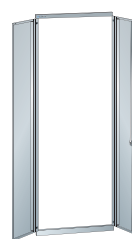

For shelf width

mm

1000

1300

Art. no.

Art. no.



Key Lock



mm

Hinged doors

2 doors* **excluding** lock
Separately lockable



● Lock (random number)

1000

55.757.XXX

55.761.XXX

2000

55.758.XXX

55.762.XXX

2200

55.759.XXX

55.763.XXX

2500

55.771.XXX

55.772.XXX

-

49.060.000

49.060.000

2 doors* **excluding** lock
Simultaneously lockable



+ Lock 2C_____ (number according to choice)

1000

55.757.XXX

55.761.XXX

2000

55.758.XXX

55.762.XXX

2200

55.759.XXX

55.763.XXX

2500

55.771.XXX

55.772.XXX

-

49.067.000

49.067.000

Lock 2C **1** (pre-defined number)

-

49.061.000

49.061.000

Lock 2C **2** (pre-defined number)

-

49.062.000

49.062.000

Lock 2C **3** (pre-defined number)

-

49.063.000

49.063.000

Lock 2C **4** (pre-defined number)

-

49.064.000

49.064.000

Lock 2C **5** (pre-defined number)

-

49.065.000

49.065.000

Lock 2C **6** (pre-defined number)

-

49.066.000

49.066.000

2 doors* **excluding** lock
Master key system



+ Lock for master key system

1000

55.757.XXX

55.761.XXX

2000

55.758.XXX

55.762.XXX

2200

55.759.XXX

55.763.XXX

2500

55.771.XXX

55.772.XXX

-

49.068.000

49.068.000

● Master key (registered system)

-

20.040.000

20.040.000



Hinged door set for Code Lock

2 doors **excluding** lock

● Electronic locking per number code

1000

55.757.XXX

55.761.XXX

2000

55.758.XXX

55.762.XXX

2200

55.759.XXX

55.763.XXX

2500

55.771.XXX

55.772.XXX

-

49.070.000

49.070.000

+ Please state the existing cylinder number for repeat orders

● Required for operation

* One door for sliding door end



Sliding doors

Two shelving sections respectively are closed with one sliding door front assembly. Running smoothly and quietly on castors: in a runner and guide rail which are fastened to the shelf supports at the bottom and/or at the top. Lockable with a lock-down cylinder lock. The lock must be ordered separately. The doors can be opened so that one entire shelving unit is freely accessible. The sliding doors can also be mounted later. Specification: sheet steel. Colour: according to colour chart.

Shelving depth with sliding door = Side panel depth + 105 mm



2 x 1000



2 x 1300



1000



1300

Cover for sliding doors

For base units with width of 27.5 mm. Can be used in conjunction with side panel covers on the left or on the right.

Specification: sheet steel. Colours: according to colour chart.

Attention: the lockable door must always be on the right. Hinged and sliding doors cannot be mounted directly next to one another. The sliding door end must not be wider than the basic units.

Art. no.

Sliding doors

-	-
55.765.XXX	55.768.XXX
55.766.XXX	55.769.XXX
55.767.XXX	55.770.XXX
55.438.000	55.438.000

-	-
55.765.XXX	55.768.XXX
55.766.XXX	55.769.XXX
55.767.XXX	55.770.XXX
55.439.000	55.439.000
55.465.000	55.465.000
55.466.000	55.466.000
55.467.000	55.467.000
55.468.000	55.468.000
55.469.000	55.469.000
55.470.000	55.470.000

-	-
55.765.XXX	55.768.XXX
55.766.XXX	55.769.XXX
55.767.XXX	55.770.XXX
55.440.000	55.440.000
20.040.000	20.040.000

Colours

Doors available in 12 standard colours. Multi-colour paint finishes also possible. When ordering, please use the desired three-digit code (instead of XXX). Customised colours on request.

For colour information see bookmark or fold-out



Sliding door end

The sliding door end closes one shelving unit when an odd number of shelving units (from 3 units) are to be equipped with sliding doors. Running smoothly and quietly on castors: in a runner and guide rail which are fastened to the side frame at the bottom and/or at the top. The door can be opened so that one entire shelving unit is freely accessible. Specification: sheet steel.

Colours: according to colour chart.

Art. no.

Sliding door end

-	-
55.773.XXX	55.776.XXX
55.774.XXX	55.777.XXX
55.775.XXX	55.778.XXX

Depth 105

Art. no.

Cover

-	-
55.779.XXX	55.780.XXX
55.781.XXX	



Key Lock for sliding doors

Standard closure with cylinder lock.

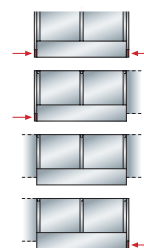

i Tip

Extending simultaneous locking

Assume that simultaneous locking is wanted for an existing shelving door and some new ones.

Solution:

1. Order the doors (e.g. in light grey) without the individual cylinders (e.g. Art. no. 55.757.020)
2. Select cylinder with the lock number of the existing cabinet (Art. no. 49.067.000) and quote the cylinder number (e.g. 2C 365)

